



# SURVEYOR'S ROOM

Originally home to Queensland's surveyors, the Surveyor's Room has been transformed into an intimate venue combining an elegant meeting room with the convenience of an adjoining annexe. These two rooms combine to offer an ideal conference facility with a breakout area for all catering requirements or an elegant cocktail prelude.

**ADDITIONAL SERVICES\***

- State of the art audiovisual equipment with touch pad controls
- Ceiling mounted data projector and 9ft automated projection screen
- Wireless internet access
- Teleconferencing facilities
- DVD and CD players
- Microphones
- Theming and floral arrangements
- Entertainment
- Electronic block out blinds

\*Charges may apply

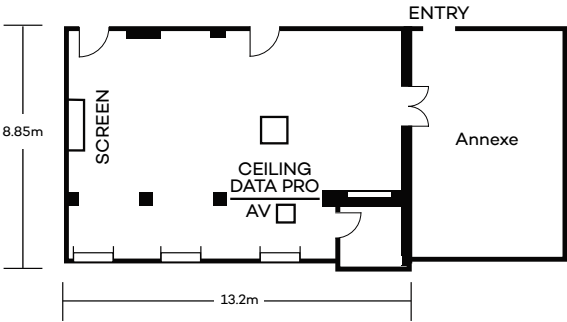

**DIMENSIONS**

MAIN 116m<sup>2</sup> (13.2m x 8.85m)  
 ANNEXE 59m<sup>2</sup> (6.7m x 8.85m)

CAPACITY							
SEATING	Theatre	Classroom	Boardroom	Cocktail	Banquet	U-Shape	Cabaret
PERSONS	80	24	28	80	50	26	40



## CABINET ROOM

The former meeting place of the State Cabinet. Rich with history, including the magnificent Queensland maple boardroom table, the Cabinet Room has hosted some of Queensland's most important gatherings. For elegant dinners to executive meetings, a prestigious menu can be curated by our award winning chefs.

### ADDITIONAL SERVICES\*

- State of the art audiovisual equipment with touchpad controls
- Ceiling mounted VGA data projector and 9ft automated projection screen
- Wireless internet access
- Teleconferencing facilities
- DVD and CD players
- Theming and floral arrangements
- Entertainment

\*Charges may apply

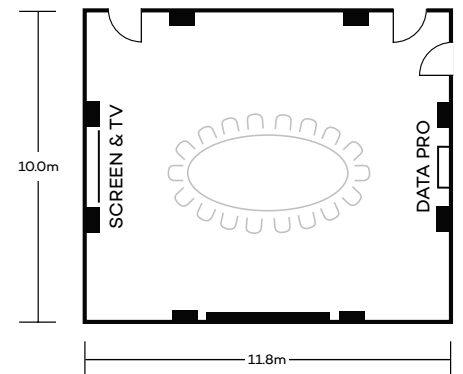

### DIMENSIONS

118m<sup>2</sup> (11.8m x 10m)

CAPACITY	
SEATING	Boardroom
PERSONS	20



## COURT LOUNGE

After moving from the Treasury Building in 1905, the Land Court held sittings in this room until 1972. The Court Lounge is elegantly restored to create the ideal setting for an intimate wedding ceremony or cocktail reception under an impressive skylight and overlooking the picturesque Queens Park.

### ADDITIONAL SERVICES\*

- Audiovisual equipment
- Wireless internet access
- Theming and floral arrangements
- Entertainment

\*Charges may apply

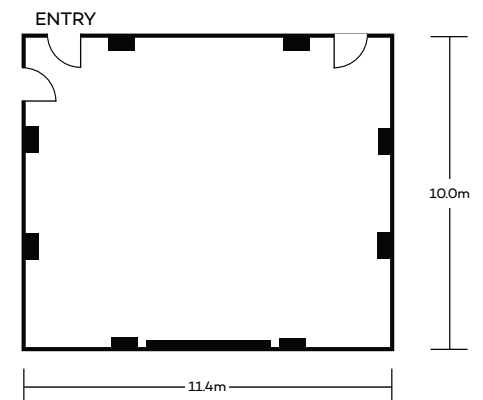

### DIMENSIONS

114m<sup>2</sup> (11.4m x 10m)

CAPACITY					
SEATING	Theatre	Cocktail	Banquet	Caberet	Boardroom
PERSONS	80	50	40	32	20



## RYAN'S PRIVATE DINING ROOM

Ryan's Private Dining Room is situated overlooking the beautiful Queens Park. The elegant dining room features the original ornate timber bar and chandeliers. Ryan's Private Dining Room offers unsurpassed elegance and is ideal for any event, corporate or social.

### ADDITIONAL SERVICES\*

- State of the art audiovisual equipment with touch pad controls
- Ceiling mounted data projector and 9ft automated projection screen
- Wireless internet access
- Teleconferencing facilities
- DVD and CD players
- Microphones
- Theming and floral arrangements
- Entertainment
- Electronic block out blinds

\*Charges may apply

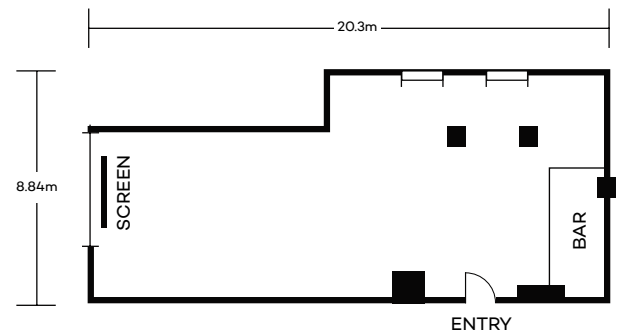

### DIMENSIONS

179m<sup>2</sup> (8.84m x 20.3m)

CAPACITY							
SEATING	Classroom	Boardroom	Cocktail	Banquet	U-Shape	Cabaret	Theatre
PERSONS	32	40	100	70	38	56	80



## MAP ROOM

Originally the site for the storage and sale of Queensland's survey maps and plans, the Map Room today provides the ideal venue for a variety of events, from a corporate conference to a themed dinner or wedding. With natural light and four metre high ceilings, the Map Room is elegantly appointed for all function requirements.

### ADDITIONAL SERVICES\*

- State of the art audiovisual equipment with touch pad controls
- Ceiling mounted data projector and 9ft automated projection screen
- Wireless internet access
- Teleconferencing facilities
- DVD and CD players
- Microphones
- Theming and floral arrangements
- Entertainment
- Electronic block out blinds

\*Charges may apply

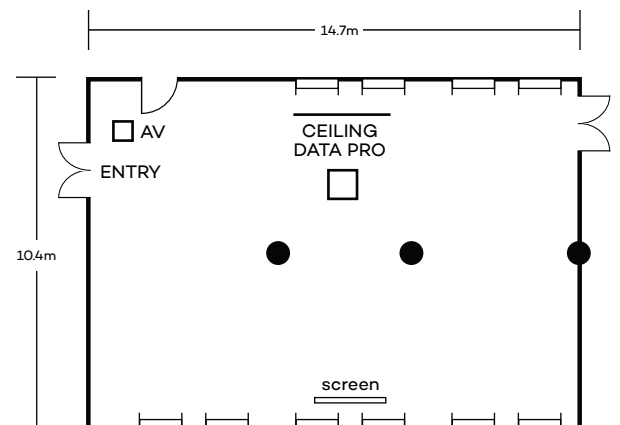

### DIMENSIONS

152m<sup>2</sup> (14.7m x 10.4m)

CAPACITY					
SEATING	Theatre	Classroom	Cocktail	Banquet	Cabaret
PERSONS	100	36	120	70	48